

5
DO NOT SCALE PRINT

4

3

2

1

REVISION				
ZONE	LTR	DESCRIPTION	DATE	APPROVED
	1	ENGINEERING RELEASE	8/16/10	V. LY

D

D

C

C

B

B

A

A

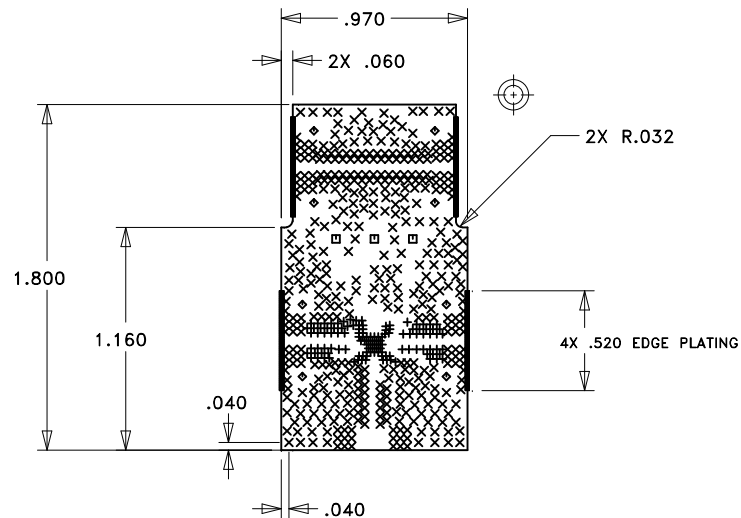

HITTITE MICROWAVE
PCB #131676-1
DRILL DRAWING

SIZE	QTY	SYM	PLATED	TOL
10	120	+	YES	FILLED
14	441	X	YES	+/-3
63	3	□	YES	+/-3
78	8	◇	YES	+/-3

LAYER	DESCRIPTION
1	RF/GND PLANE
2	GND PLANE
3	GND PLANE
4	BOTTOM GND PLANE

NOTES:

UNLESS OTHERWISE SPECIFIED:

- MATERIAL: MULTILAYER. OVERALL STACKUP AS SHOWN. TYPE ARLON 25FR OR ROGERS 4350, HALF OUNCE COPPER BOTH SIDES. FR4 TO BE USED AS FILLER TO MEET CRITICAL OVERALL THICKNESS.
- FINISH: GOLD PLATE PER ASTM B-488, TYPE III, CODE A, 8 TO 40 MICROINCHES, OVER NICKEL PER QQ-N-290, 100 MICROINCHES MINIMUM.
- PLATED THRU HOLES: .001 MINIMUM WALL THICKNESS.
- HOLE SIZES AND POSITIONS PER ARTWORK AND/OR DRILL FILE.
- ALL HOLES TO BE LOCATED WITHIN $\pm .003$ OF THE CENTER OF THE PAD OR OTHER TRUE POSITION.
- FRONT TO BACK REGISTRATION $\pm .003$ MAX.
- BOARD WARPAGE: $< .010$ PER LINEAR INCH.
- SILKSCREEN TOP SIDE ONLY WITH WHITE EPOXY INK.
- SOLDERMASK: LPI SOLDERMASK TOP SIDE. COLOR: GREEN REGISTRATION: $\pm .004$ MAX.
- "SIZE" IN DRILL LEGEND IS IN MILS AND REFERS TO FINISHED HOLE SIZE.
- MANUFACTURE PER IPC-6012 CLASS 2.

SPECIAL REQUIREMENTS:

- CRITICAL LINE WIDTH = $.016 \pm .001$ ON METAL-01. ADJUST PROCESS TO ACHIEVE WIDTH. CRITICAL LINE WIDTH = $.018 \pm .001$ ON METAL-01. ADJUST PROCESS TO ACHIEVE WIDTH.
- EDGE PLATING MUST CONNECT ALL FOUR LAYERS.
- ALL .010 SIZE VIAS TO BE FILLED WITH NON-CONDUCTIVE VIA FILL AND OVERPLATED WITH Cu BOTH SIDES.

VENDOR NOTES:

- VENDOR MAY ADD E-TEST STAMP TO PCB. VENDOR SHALL NOT ADD NAME, LOGO, DATE CODE, UL LISTING OR ANY OTHER MARKING TO ANY VISIBLE LAYER.
- BOARDS MUST PASS VISUAL INSPECTION PER IPC-A-600 CLASS 2.

PROPRIETARY TO HITTITE MICROWAVE CORPORATION

UNLESS OTHERWISE SPECIFIED:	
DIMENSIONS ARE IN INCHES (MM)	
DRAWING PRACTICES PER ASME Y14.100	
INTERPRET DIMENSIONS & TOLERANCES PER ASME Y14.5-2009	
TOLERANCES:	
.XX	+/- 0.010
.XXX	+/- 0.005
.XXXX	+/- 0.002
ANGLES	+/- .5 DEG

DWN BY:	V. LY	08/05/2010
ENGINEER:	SELEN KILINC	



HITTITE MICROWAVE CORPORATION
20 Alpha Road Chelmsford, MA 01824

TITLE
PCB, EVAL
HMC5694LC4B

SIZE	CODE ID NO.	DRAWING NO.	REV
A	1CN88	131676	1
SCALE: NONE		WT	SHEET 1 of 1

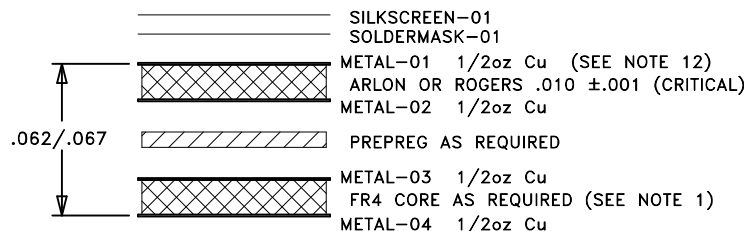

LAYER STACKUP

5

4

3

2

1