

CHARACTERISTIC IMPEDANCE:
50 OHM'S +/- 10% ARTWORK LINE WIDTH .0085"
100 OHM DIFFERENTIAL ARTWORK LINE .005" TRACE / .005" SPACE

DRILL CHART: TOP to BOTTOM			
ALL UNITS ARE IN MILS			
FIGURE	SIZE	PLATED	QTY
+	10.0	PLATED	213
□	12.0	PLATED	46
°	16.0	PLATED	128
◆	20.0	PLATED	361
⊙	30.0	PLATED	137
○	SEE SLOT DETAIL	PLATED	3
◇	40.0	PLATED	39
◊	50.0	PLATED	10
⊠	160.0	NON-PLATED	7

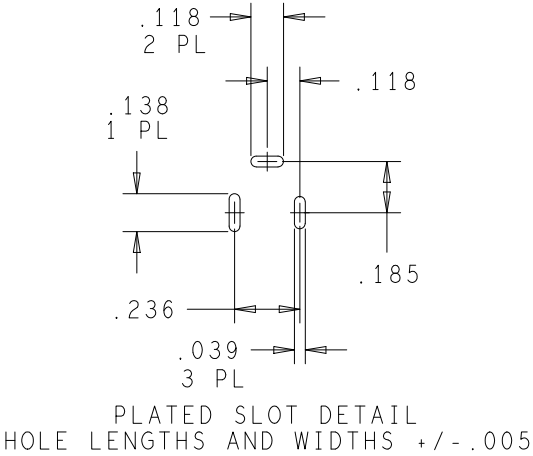

NOTES: MATERIALS; MANUFACTURE TO MEET EU RoHS DIRECTIVE. ALL MATERIAL, (INCLUDING SOLDERMASK) REFER TO EU RoHS DIRECTIVE 20002/95/EC.
LAMINATE & RESIN MATERIALS; Tg>170C. Td>310c
ACCEPTABLE MATERIALS; NELCO N4000-11, NELCO N40000-29, ISOLA IS410, POLYCLAD 370 HR, FR4-08.
CLADDING; EXTERNAL LAYERS 1/2 OZ. COPPER, OVERPLATE TO 1 1/2 OZ. INTERNAL SIGNAL LAYERS 1 OZ. COPPER. INTERNAL PLANE LAYERS 1 OZ. COPPER.
SOLDER MASK; SHALL BE BLUE LIQUID PHOTOIMAGABLE (LPI) APPLIED ON BOTH SIDES OVER BARE COPPER AND SHALL MEET IPC-SM-840 (LATEST REV.) CLASS 3.
SILK SCREEN; SHALL BE PERMANENT NON-CONDUCTIVE EPOXY INK, COLOR WHITE.
U.L. RATING; 94VO MINIMUM.
FINISH; HARD GOLD.

- FABRICATION:
- REFER TO IPC-4101B/99 SERIES (LATEST REV.), CLASS 2 FOR FABRICATION UNLESS OTHERWISE SPECIFIED.
 - UNDIMENSIONED HOLES TO BE LOCATED WITHIN +/- .005 OF THEIR TRUE POSITION WITH RESPECT TO ARTWORK.
 - PLATED HOLE WALL THICKNESS SHALL NOT BE LESS THAN .001 INCH MINIMUM AVERAGE, WITH NO READING LESS THAN .0008 BY CROSS SECTION.
 - HOLE DIAMETERS APPLY AFTER PLATING.
 - FINISHED CONDUCTOR WIDTHS SHALL NOT BE REDUCED FROM THE NOMINAL, INDICATED ON THE MASTER PATTERN, BY MORE THAN THE CONDUCTOR THICKNESS.
 - MINIMUM DESIGN LINE WIDTH IS .005 INCH.
 - MINIMUM DESIGN SPACING IS .005 INCH.
 - BOARD/PANEL MUST MEET IPC-A-600 (LATEST REV.) CLASS 2 FOR FLATNESS.
 - MFGR. TO LEGIBLY ETCH OR STAMP/SCREEN WITH PERMANENT NON-CONDUCTIVE INK ON SECONDARY SIDE IN A CLEAR AREA UNLESS OTHERWISE INDICATED;
 - NON-FUNCTIONAL PADS MAY BE REMOVED FROM INNER SIGNAL LAYERS AT MFGR. DISCRETION.
 - IF PAD SIZES PROVIDED ARE NOT LARGE ENOUGH TO MAINTAIN ANNULAR RING REQUIREMENT, MFGR. MAY TEAR DROP PADS TO MAINTAIN ANNULAR RING AT PAD TO CIRCUIT INTERFACE ONLY AND MUST INSURE ELECTRICAL INTEGRITY.
 - REPAIRS PER IPC-R-700 ARE ALLOWED.
 - MODIFICATIONS TO THE ARTWORK, OTHER THAN THOSE DESCRIBED ON THE FABRICATION DRAWING, ARE NOT ALLOWED WITHOUT WRITTEN AUTHORIZATION.
 - HOLES , 0.010 DRILL, ARE TO BE SOLDERMASK PLUGGED, PLANARIZED, AND PLATED OVER.

FIDUCIALS; TOP & BOTTOM ARE MIRRORED COPIES,
(-1150,-1550), (-1140, 1600), (2675, 1975) & (2725,-1695)

6 LAYER STACKUP	
PRIMARY SILKSCREEN	
PRIMARY SOLDER MASK	
PRIMARY SIDE (LAYER 1)	
RETURN PLANE (LAYER 2)	
.003"	POWER PLANE (LAYER 3)
FILLER	POWER PLANE (LAYER 4)
.003"	RETURN PLANE (LAYER 5)
SECONDARY SIDE (LAYER 6)	
SECONDARY SOLDER MASK	
SECONDARY SILKSCREEN	

UNLESS OTHERWISE SPECIFIED DIMENSIONS ARE IN INCHES		TOLERANCES		DECIMALS FRACTIONS ANGLES		.XX .010 .1/32 .2		.XXX .005	
FABRICATION		APPROVAL		DATE		TITLE		HSC DIVISION 7910 TRIAD CTR. DR. GREENSBORO, NC 27409	
MATERIAL		DRAWN BY GSO		29APR10		AD9644 ENG.EVAL. PCB			
FINISH		DESIGNED				SIZE		FSCM NO	
		CHECKED				D		DRAWING NUMBER	
		APPROVED						9644CE01	
		MFG ENGINEER						REV	
								A	
DO NOT SCALE DWG				SCALE		2/1		SHEET 1 OF 1	