

ECO	REV	DESCRIPTION	DATE	APPROVED
	1	PROD	12/12/07	

NOTES: UNLESS OTHERWISE SPECIFIED,

1. ARTWORK P/N DC1185B REV 1.
2. FAB PER IPC-A-800
3. PCB SHALL BE RoHS COMPLIANT.
4. MATERIAL:
 - A. LAMINATE: EPOXY FIBERGLASS, NEMA GRADE FR-4
 - B. THICKNESS: 1.6 +/- 0.1 mm
 - C. CLAD: 2 OZ. (50um) EXTERNAL LAYERS.
1 OZ. (25um) COPPER ON FOUR INTERNAL LAYERS.
5. FINISH:
 - A. COATING: SOLDERMASK OVER BARE COPPER,
COLOR, GREEN LPI.
 - B. PLATING: GOLD IMMERSION BOTH SIDES.
 - C. SILKSCREEN: COMPONENT SIDE WITH WHITE
NON-CONDUCTIVE INK.
6. TOLERANCES:
 - A. WARPAGE: (0.075mm) MAX. ALONG THE LONGEST DIAG.
AS PER IPC-TM650 METHOD 2.4.22.
 - B. ETCHING: +0.03mm, -0.3mm OF MASTER PATTERN.
 - C. REGISTRATION: 0.075mm MAX.
 - D. MASK THICKNESS: 0.025mm MIN., 0.075mm MAX.
 - E. HOLE PLATING: 22um +/- 3um.

7. SIZE:

- A. CUT TO DIMENSIONS AND TOLERANCES SHOWN.
0.00 ARE PRIMARY DATUMS.
8. HOLE DIAMETERS ARE POST-PLATED SIZES.
9. DEBURR AND BREAK ALL SHARP EDGES.
10. DO NOT ALTER ARTWORK e.g. TO ADD LOGO OR DATE CODE.

SIZE	QTY	SYM	PLATED	TOL
0.25	138	+	YES	+/-0.08
0.76	10	□	YES	+/-0.08
1.78	2	◇	NO	+/-0.13
2.41	12	⊠	YES	+/-0.13
5.21	6	⊠	YES	+/-0.25

A cross-sectional diagram of a six-layer printed circuit board (PCB). The layers are labeled on the right side with leader lines pointing to each layer. From top to bottom, the labels are: L1 - TOP COMPONENT SIDE, L2 - GROUND PLANE, L3 - TRACE PLANE, L4 - TRACE PLANE, L5 - GROUND PLANE, and L6 - BOTTOM COMPONENT SIDE. The diagram shows alternating conductive layers (L1, L3, L4, L6) and insulating core or prepreg layers (L2, L5). The top and bottom layers (L1 and L6) are thicker than the internal layers.

UNLESS OTHERWISE SPECIFIED
DIMENSIONS ARE IN MILLIMETERS
TOLERANCES ON ANGLE $\pm 1^\circ$

.XX ± .25

.XXX ± .127

THIRD ANGLE PROJECTION

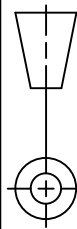

DO NOT SCALE DRAWING

CONTRACT NO.

APPROVALS		DATE
DRAWN	MEI	12/12/07
CHECKED		
APPROVED		
DESIGNED BY		

TITLE

**FAB, LTC3850EUF, DUAL OUTPUT
SYNCHRONOUS BUCK CONVERTER**

SIZE	CAGE CODE	DWG NO.	REV
A		DC1185B	1
SCALE	1/1	FILENAME: 1185B-1.PCB	SHEET 1 OF 1



1630 McCarthy Blvd.
Milpitas, CA 95035
Phone: (408)432-1900
Fax: (408)434-0507