

DIM	INCHES		MILLIMETERS	
	MIN	MAX	MIN	MAX
A	0.093	0.104	2.35	2.65
A1	0.004	0.012	0.10	0.30
B	0.014	0.019	0.35	0.49
C	0.009	0.013	0.23	0.32
D	0.697	0.713	17.70	18.10
e	0.050 BSC		1.27 BSC	
E	0.291	0.299	7.40	7.60
F	0.0	0.040	0.0	1.02
H	0.394	0.419	10.00	10.65
h	0.010	0.030	0.25	0.75
L	0.016	0.050	0.40	1.27
$\alpha$	0°	8°	0°	8°

Pkgcode: W28M-9

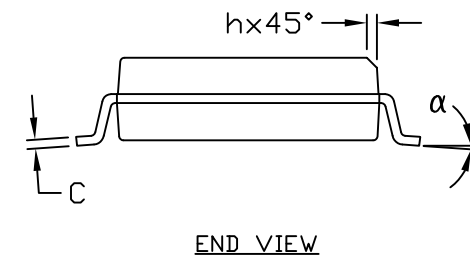
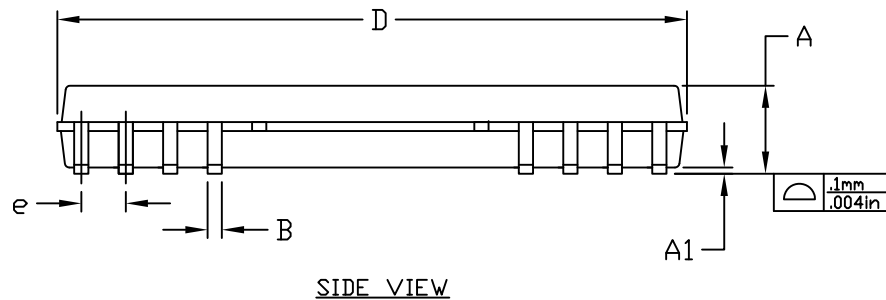

NOTES:

1. CONTROLLING DIMENSIONS: MILLIMETERS.
2. MATERIAL MUST COMPLY WITH BANNED AND RESTRICTED SUBSTANCES SPEC # 10-0131.
3. DIMENSIONS D AND E DO NOT INCLUDE MOLD FLASH.
4. MOLD FLASH OR PROTRUSIONS NOT TO EXCEED 0.15mm (.006").
5. MARKING SHOWN IS FOR PKG. ORIENTATION REFERENCE ONLY.
6. SIMILAR TO JEDEC MS013 AE.
7. N=28, ACTUAL # OF PINS=16.
8. ALL DIMENSIONS APPLY TO BOTH LEADED (-) AND PbFREE (+) PKG. CODES.

-DRAWING NOT TO SCALE-

<b>MAXIM</b>			
TITLE: PACKAGE OUTLINE, 28L SOIC .300" (HYBRID)			
APPROVAL ARNALDO FLERAS 1/11/11	DOCUMENT CONTROL NO. 21-0145	REV. B	1/1