

TOP VIEW

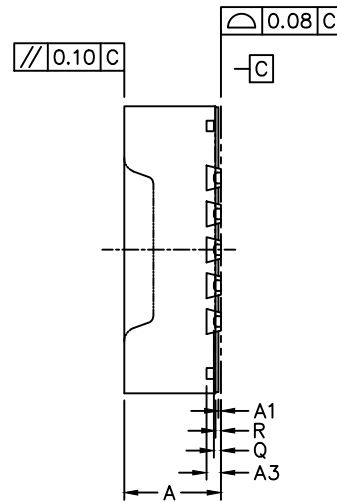

SIDE VIEW

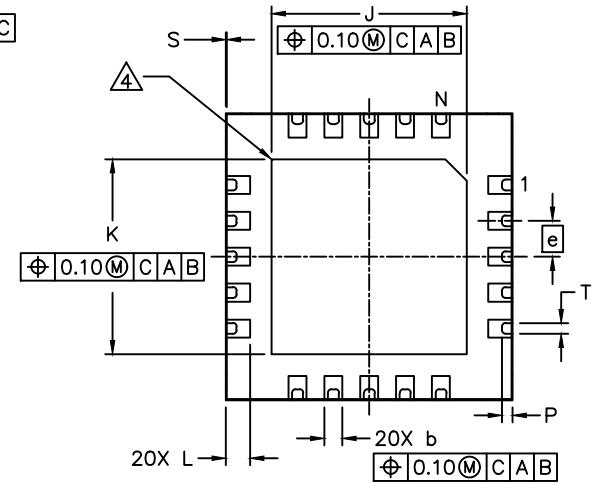

BOTTOM VIEW

NOTES:

1. ALL DIMENSION AND TOLERANCE CONFORM TO ASME Y14.5M-1994.
2. ALL DIMENSION ARE IN MILLIMETERS UNLESS OTHERWISE SPECIFIED.
3. N IS THE TOTAL NUMBER OF TERMINALS.
4. BILATERAL COPLANARITY ZONE APPLIES TO THE EXPOSED PAD AS WELL AS THE TERMINALS.
5. ALL DIMENSION APPLY TO BOTH LEADED (-) AND PbfREE (+) PKG. CODES.
6. DRAWING CONFORMS TO JEDEC MO-220.
7. MARKING SHOWN IS FOR PACKAGE ORIENTATION REFERENCE ONLY.
8. CONTROLLING DIMENSION: mm.
9. PKG. CODE: Q2044Y-2
10. MATERIAL MUST BE COMPLIANT WITH MAXIM SPECIFICATION 10-0131 FOR SUBSTANCE CONTENT, MUST BE Eu ROHS COMPLIANT WITHOUT EXEMPTION AND PB-FREE.

| COMMON DIMENSIONS |       |       |       |
|-------------------|-------|-------|-------|
| DIM               | MIN.  | NOM.  | MAX.  |
| A                 | 1.30  | 1.35  | 1.40  |
| A1                | 0     | 0.035 | 0.05  |
| A3                | 0.203 |       | REF   |
| b                 | 0.20  | 0.25  | 0.30  |
| e                 | 0.50  |       | BSC   |
| D                 | 3.90  | 4.00  | 4.10  |
| E                 | 3.90  | 4.00  | 4.10  |
| J                 | 2.62  | 2.72  | 2.82  |
| K                 | 2.62  | 2.72  | 2.82  |
| L                 | 0.290 | 0.34  | 0.390 |
| R                 | 0.075 | ---   | ---   |
| S                 | 0     | 0.015 | 0.03  |
| T                 | 0.15  |       | REF   |
| P                 | 0.15  |       | REF   |
| Q                 | 0.1   |       | REF   |
| N                 | 20    |       |       |



TITLE:  
PACKAGE OUTLINE, 20L DC-SWQFN  
4X4X1.35

|          |                                   |           |     |
|----------|-----------------------------------|-----------|-----|
| APPROVAL | DOCUMENT CONTROL NO.<br>21-100404 | REV.<br>B | 1/1 |
|----------|-----------------------------------|-----------|-----|

-DRAWING NOT TO SCALE-