

TOP VIEW

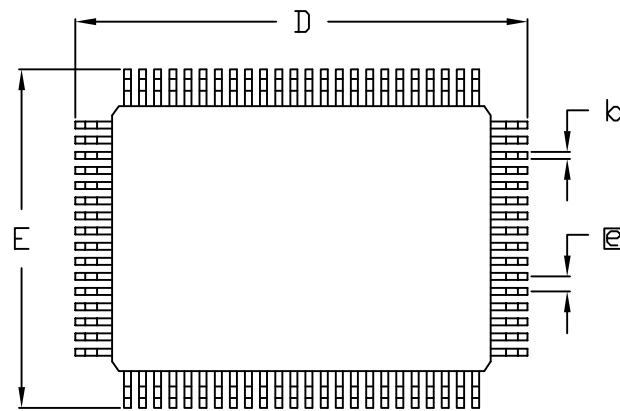

BOTTOM VIEW

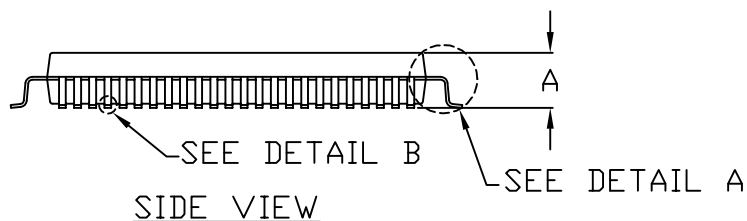

SIDE VIEW

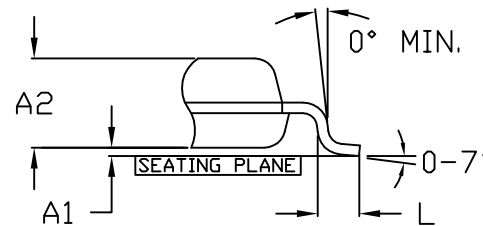

DETAIL A

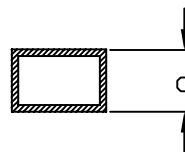

DETAIL B

SYMBOL	DIMENSIONS	
	MIN.	MAX.
A	$\approx$	3.40
A1	0.10	0.50
A2	2.55	2.87
D	23.70	24.10
D1	19.90	20.10
E	17.70	18.10
E1	13.90	14.10
L	0.65	0.95
N	80	
e	0.80 BSC.	
b	0.30	0.45
c	0.13	0.23
PKG. CODE	M80-1, M80-2, M80-3, M80-4	

NOTES:

1. DIMENSIONS D1 AND E1 INCLUDE MOLD MISMATCH, BUT DO NOT INCLUDE MOLD PROTRUSION. ALLOWABLE MOLD PROTRUSION IS 0.254 MM PER SIDE.
2. DETAILS OF PIN 1 IDENTIFIER ARE OPTIONAL BUT MUST BE LOCATED WITHIN THE ZONE INDICATED.
3. DIMENSION b DOES NOT INCLUDE DAMBAR PROTRUSION. ALLOWABLE DAMBAR PROTRUSION SHALL BE 0.08mm TOTAL IN EXCESS OF THE b DIMENSION AT MAXIMUM MATERIAL CONDITION. PROTRUSION NOT TO BE LOCATED ON LOWER RADIUS OR FOOT OF LEAD.
4. ALL DIMENSIONS ARE IN MILLIMETERS UNLESS SPECIFIED OTHERWISE.
5. MATERIAL MUST COMPLY WITH BANNED AND RESTRICTED SUBSTANCES SPEC# 10-0131
6. ALL DIMENSIONS APPLY TO BOTH LEADED (-) AND PbFREE (+) PKG. CODES.



TITLE:  
PACKAGE OUTLINE,  
80L MQFP, 14X20X3mm, 1.95 FORM

APPROVAL  
RAMON DE LEON  
12/22/09

DOCUMENT CONTROL NO.  
21-0271

REV. B 1/1