

SIZE	QTY	SYM	PLTD	TOL
40	15	+	YES	+/-0.0
70	2	X	NO	+/-0.0
95	7	□	YES	+/-0.0
15	22	◇	YES	+/-0.0
20	2	⊗	YES	+/-0.0

- ART01 = LAYER 1 (COMPONENT SIDE)
- ART02 = LAYER 2 (GND)
- ART03 = LAYER 3 (SIGNAL)
- ART04 = LAYER 4 (SOLDER SIDE)

NOTES : Unless Otherwise Specified

- MATERIAL : FR4 OR EQUIVALENT EPOXY, 2 OZ. COPPER CLAD
THICKNESS .062 +/--.006 TOTAL OF 4 LAYERS
- FINISH : ALL PLATED HOLES .001 MIN. / .0015 MAX. COPPER PLATE
ELECTRODEPOSITED TIN-LEAD COMPOSITION
BEFORE REFLOW , SOLDER MASK OVER BARE COPPER (SNOBC)
- SOLDER MASK : BOTH SIDES USING LPI OR EQUIVALENT
- SILKSCREEN : USING WHITE NON-CONDUCTIVE EPOXY INK
- ALL DIMENSIONS ARE IN INCHES
- SCORING:

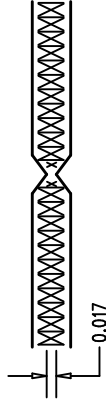

Fabrication Drawing

APPROVALS		LINEAR TECHNOLOGY		1630 McCarthy Blvd. Milpitas, CA 95035 PH: (408)432-1900	
DRAWN	INIT	DATE			
CHECK					
DESIGN			TITLE: LTC3548EDD		
ENGR			Dual Synchronous Step-Down DC/DC Converter		
			SIZE	A	Rev 0
SCALE = NONE			DES- DEMO CIRCUIT 822A		
			SHT 1 of 1		