

LTC CONFIDENTIAL - For Customer Use Only

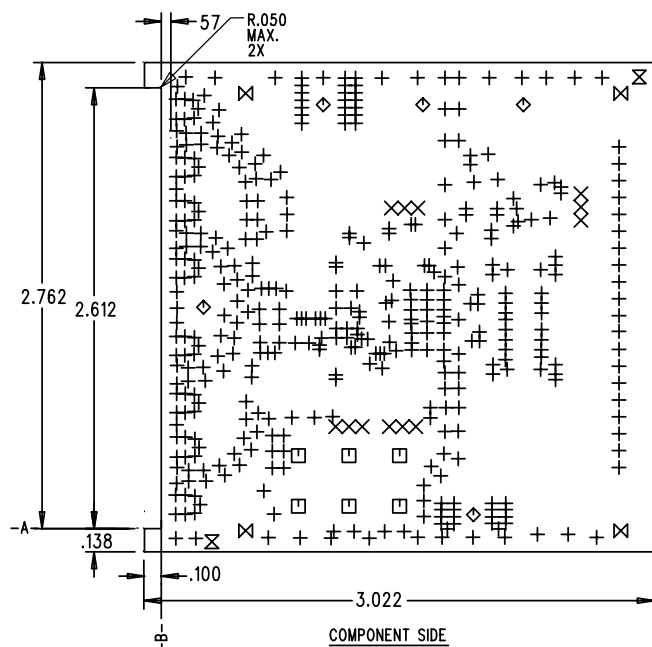

REVISION HISTORY				
ECO	REV	DESCRIPTION	DATE	APPROVED
	1	CHG SILKSCREEN FOR VARIOUS IC'S; DEMO NO. WAS 520A REV.3	9/12/02	
	2	REMOVE NOTE 11 (EXPOSED COPPER-INNER LAYER)	11/7/03	

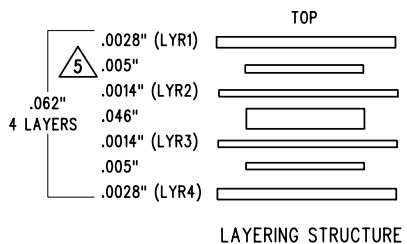

HOLE SIZE CHART			
SYM	SIZE	QTY	PTH
+	.012+/- .003	419	YES
X	.030+/- .003	12	YES
□	.035+/- .003	6	YES
◇	.064+/- .003	5	YES
⊗	.070+/- .003	2	NO
⊠	.125+/- .003	4	YES

NOTES: UNLESS OTHERWISE SPECIFIED

- ARTWORK P/N DC520B REV 2.
- FAB PER IPC-A-600
- MATERIAL: FR406 (GETEK)
FINISHED THICKNESS TO BE .062 +/- .005 INCH
WITH 2 OZ. COPPER ON TWO OUTER LAYERS AND
1 OZ. COPPER ON TWO INTERNAL LAYERS.
FLAMABILITY RATING: 94 V-0 MINIMUM .
- OUTER DIELECTRIC THICKNESS: TARGET 50-OHM USING 8 MIL
TRACE CONTROLLED 50 OHM IMPEDANCE LAYER 1 TO
LAYER 2. (TO BE FINALIZED BY MANUFACTURER)
- SUBJECT TO CHANGE BY MANUFACTURER, DEPENDING ON
DIELECTRIC CONSTANT DEVIATIONS. PLEASE CONSULT LTC.
- SIZE: CUT TO DIMENSIONS AND TOLERANCES SHOWN.
-A- AND -B- ARE PRIMARY DATUMS.
- DRILLING: DRILL HOLES PER SCHEDULE. PLATE THROUGH
HOLES WITH COPPER, .001 INCH THICK MIN. ALL
HOLE SIZES ARE SPECIFIED AFTER PLATING.
HOLE LOCATION TOLERANCES ARE +/- .003
INCH IN RELATION TO CENTER
- FINISH: SMOBC USING LPI BOTH SIDES, GREEN PREFERABLE.
SILKSCREEN BOTH SIDES WITH WHITE NON-CONDUCTIVE
INK.
- DROP ALL UNUSED PADS ON INNER LAYERS.
- DO NOT ALTER ARTWORK e.g. TO ADD LOGO OR DATE CODE.
- SCORING:

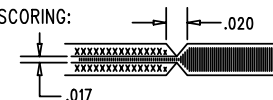

UNLESS OTHERWISE SPECIFIED
DIMENSIONS ARE IN INCHES
TOLERANCES ON ANGLE $\pm 1^\circ$
2 PLACE ± 0.1 3 PLACE ± 0.05
INTERPRET DIM AND TOL
PER ASME Y14.5M - 1994

THIRD ANGLE PROJECTION

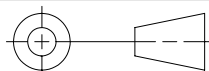

DO NOT SCALE DRAWING

CONTRACT NO

APPROVALS		DATE
DRAWN	L.SANTOS	6/3/02
CHECKED		
APPROVED		
ENGINEER	R.REAY	6/3/02



1630 McCarthy Blvd.
Milpitas, CA 95035
Phone: (408)432-1900
Fax: (408)434-0507

TITLE

FAB, LTC174X, 14-BIT/80 MSPS DEMO PCB

SIZE	CAGE CODE	DWG NO	REV
A		DC520B	2
SCALE 1/1		FILENAME: 520Br2.PCB	SHEET 1 OF 1