

SH	1
----	---

REV	1
-----	---

REVISION HISTORY				
ECO	REV	DESCRIPTION	DATE	APPROVED
	1	DEMO BOARD RELEASE	02/26/01	

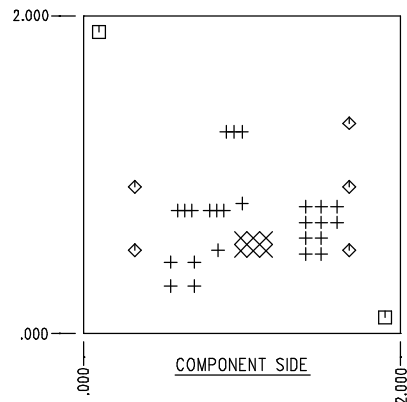

HOLE SIZE CHART			
SYM	SIZE	QTY	PTH
+	.020+/- .003	25	YES
×	.035+/- .003	6	YES
□	.070+/- .003	2	NO
◇	.094+/- .003	5	YES
⊗			
⊗			

1. ARTWORK P/N DC376A REV 1.
2. FAB PER IPC-A-600
3. MATERIAL: EPOXY FIBERGLASS, NEMA GRADE FR-4  
FINISHED THICKNESS TO BE .062 +/- .005 INCH  
WITH 2 OZ. COPPER ON BOTH SIDES.  
FLAMMABILITY RATING: 94 V-0 MINIMUM .
4. SIZE: CUT TO DIMENSIONS AND TOLERANCES SHOWN.  
0.00 ARE PRIMARY DATUMS.
5. DRILLING: DRILL HOLES PER SCHEDULE. PLATE THROUGH HOLES  
WITH COPPER, .001 INCH THICK MIN. ALL HOLE SIZES  
ARE SPECIFIED AFTER PLATING.  
HOLE LOCATION TOLERANCES ARE +/- .003 INCH IN  
RELATION TO CENTER
6. FINISH: SMOBC USING WET MASK, OR LPI BOTH SIDES, GREEN  
PREFERRABLE. SILKSCREEN COMPONENT SIDE WITH WHITE  
NON-CONDUCTIVE INK.
7. DO NOT ALTER ARTWORK e.g. TO ADD LOGO OR DATE CODE.
8. V-SCORE BOTH SIDES:

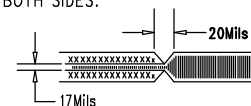

CONTRACT NO	
APPROVALS	DATE
DRAWN L.SANTOS	10/3/00
CHECKED	
APPROVED	
ENGINEER	



1630 McCarthy Blvd.  
Milpitas, CA 95035  
Phone: (408)432-1900  
Fax: (408)434-0507

FAB, LTC1701B, 0.5A DC/DC CONVERTER PCB

SIZE A	CAGE CODE	DWG NO DC376A	REV 1
-----------	-----------	------------------	----------

SCALE 1/1	FILENAME: 376Ar1.PCB	SHEET 1 OF 1
-----------	----------------------	--------------

### THIRD ANGLE PROJECTION

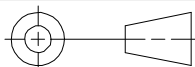

DO NOT SCALE DRAWING