

LTC CONFIDENTIAL – For Customer Use Only



DWG NO DC326B

SH 1

REV 2

REVISION HISTORY

ECO	REV	DESCRIPTION	DATE	APPROVED
	2	DEMO BOARD RELEASE; ADD C12	05/24/01	

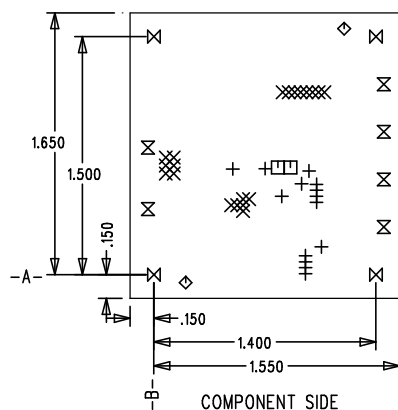

SIZE	QTY	SYM	PLTD
12	14	+	PLTD
20	20	X	PLTD
35	2	□	PLTD
70	2	◇	NPLTD
95	6	⊗	PLTD
125	4	⊗	PLTD

NOTES: UNLESS OTHERWISE SPECIFIED

- ARTWORK P/N DC326B REV 2.
- FAB PER IPC-A-600
- MATERIAL: EPOXY FIBERGLASS, NEMA GRADE FR-4  
FINISHED THICKNESS TO BE .062 +/- .005 INCH  
WITH 2 OZ. COPPER ON BOTH SIDES.  
FLAMABILITY RATING: 94 V-0 MINIMUM .
- SIZE: CUT TO DIMENSIONS AND TOLERANCES SHOWN.  
-A- AND -B- ARE PRIMARY DATUMS.
- DRILLING: DRILL HOLES PER SCHEDULE. PLATE THROUGH HOLES  
WITH COPPER, .001 INCH THICK MIN. ALL HOLE SIZES  
ARE SPECIFIED AFTER PLATING.  
HOLE LOCATION TOLERANCES ARE +/- .003 INCH IN  
RELATION TO CENTER
- FINISH: SMOBC USING LPI BOTH SIDES, GREEN PREFERABLE.  
SILKSCREEN COMPONENT SIDE WITH WHITE NON-  
CONDUCTIVE INK.
- DO NOT ALTER ARTWORK e.g. TO ADD LOGO OR DATE CODE.
- SCORING:

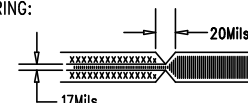

UNLESS OTHERWISE SPECIFIED  
DIMENSIONS ARE IN INCHES  
TOLERANCES ON ANGLE  $\pm 1^\circ$   
2 PLACE  $\pm 0.1$  3 PLACE  $\pm 0.05$   
INTERPRET DIM AND TOL  
PER ASME Y14.5M - 1994

THIRD ANGLE PROJECTION

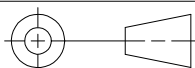

DO NOT SCALE DRAWING

CONTRACT NO

APPROVALS

DATE

DRAWN L.SANTOS

01/11/01

CHECKED

APPROVED

ENGINEER



1630 McCarthy Blvd.  
Milpitas, CA 95035  
Phone: (408)432-1900  
Fax: (408)434-0507

TITLE

FAB, LT1766, 1.5A 200KHz HIGH VOLTAGE BUCK CONVERTER PCB

SIZE  
A

CAGE CODE

DWG NO

DC326B

REV  
2

SCALE 1/1

FILENAME: 326Br2.PCB

SHEET 1 OF 1

