

REVISION HISTORY			
ECO	REV	DESCRIPTION	APPR DATE
-	3	PRODUCTION	KEITH S. 1-31-12

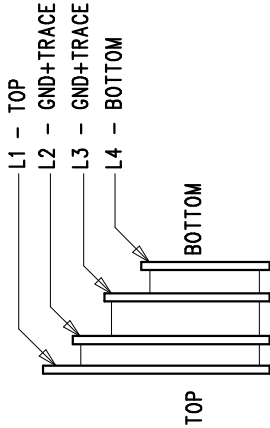

NOTES: UNLESS OTHERWISE SPECIFIED

1. FAB PER IPC-A-600.
2. MATERIAL: -EPOXY FIBERGLASS, NEMA GRADE FR-4  
-FINISHED THICKNESS TO BE 0.062 +/- .005  
-TOTAL OF 4 LAYERS WITH 2 OZ. CU ON THE OUTER LAYERS AND 1 OZ. CU ON THE INNER LAYERS.  
-FLAMMABILITY RATING: 94 V-0 MINIMUM.
3. SIZE: CUT TO DIMENSIONS AND TOLERANCES SHOWN.  
0.00 ARE PRIMARY DATUMS.
4. DRILLING: -DRILL HOLES PER SCHEDULE. PLATE THROUGH HOLES WITH COPPER, 0.001 THICK MIN.  
-ALL HOLE SIZES ARE SPECIFIED AFTER PLATING.  
-HOLE LOCATION TOLERANCES ARE +/-0.003 IN RELATION TO CENTER
5. FINISH: -SMOBC USING LPI BOTH SIDES, COLOR GREEN.  
-GOLD IMMERSION BOTH SIDES.  
-FOR SILKSCREEN: USE WHITE NON-CONDUCTIVE INK.
6. DO NOT ALTER ARTWORK e.g. TO ADD LOGO OR DATE CODE. PAD SIZE CAN BE MODIFIED TO MEET END FINISH.
7. PCBs ARE TO BE RoHS COMPLIANT.
8. SCORING FOR PANELIZED PCB:

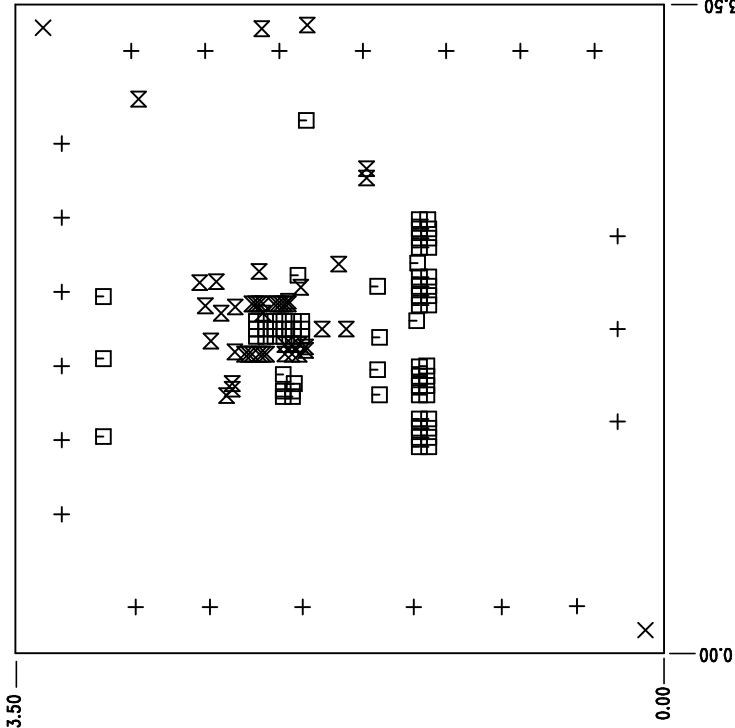
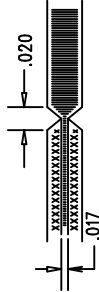

UNLESS OTHERWISE SPECIFIED		APPROVALS	
DIMENSIONS ARE IN INCHES		PCB DES.	HZ
TOLERANCES:		APP ENG.	KEITH S.
0.XX = ± 0.01			
0.XXX = ± 0.005			
INTERPRET DIM AND TOL PER ASME Y14.5M-1994			
THIRD ANGLE PROJECTION			
		SCALE = NONE	
		SIZE	IC NO.
		N/A	LT3791EFE
		REV	3
		FILENAME:	DC1666A-3.PCB
		SHT	1 OF 1

1630 MCCARTHY BLVD  
MILPITAS, CA 95035  
TEL: (408) 432-1800  
FAX: (408) 432-1800  
LTC CONFIDENTIAL -  
FOR CUSTOMER USE ONLY



TITLE: FABRICATION DRAWING  
FOUR-SWITCH BUCK-BOOST  
LED DRIVER CONTROLLER